

# Station 252 Manual

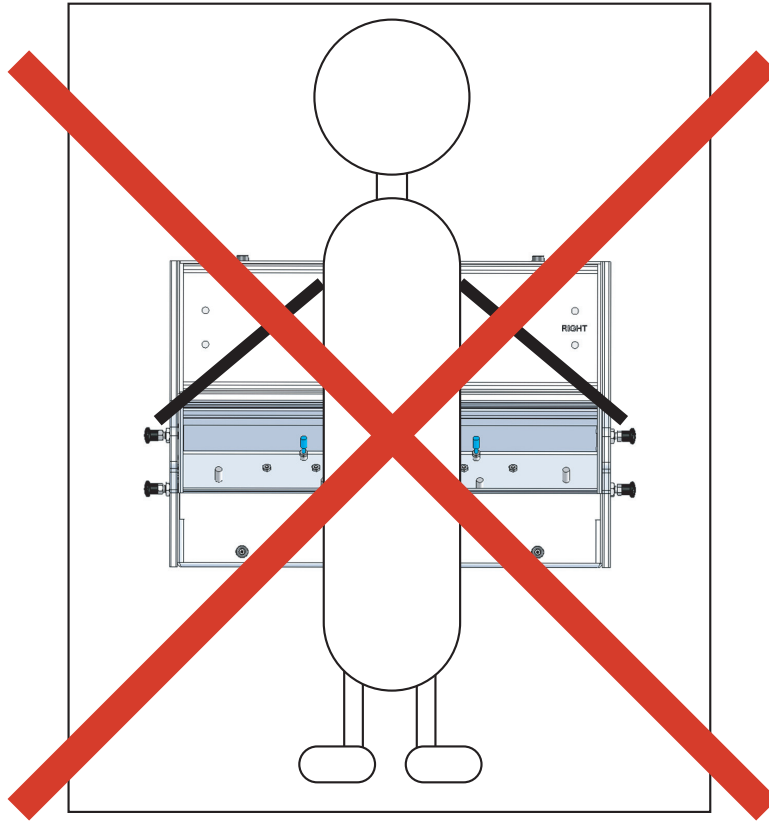

Version 1.1

# WARNING!!



**Do NOT pull both locking pins**

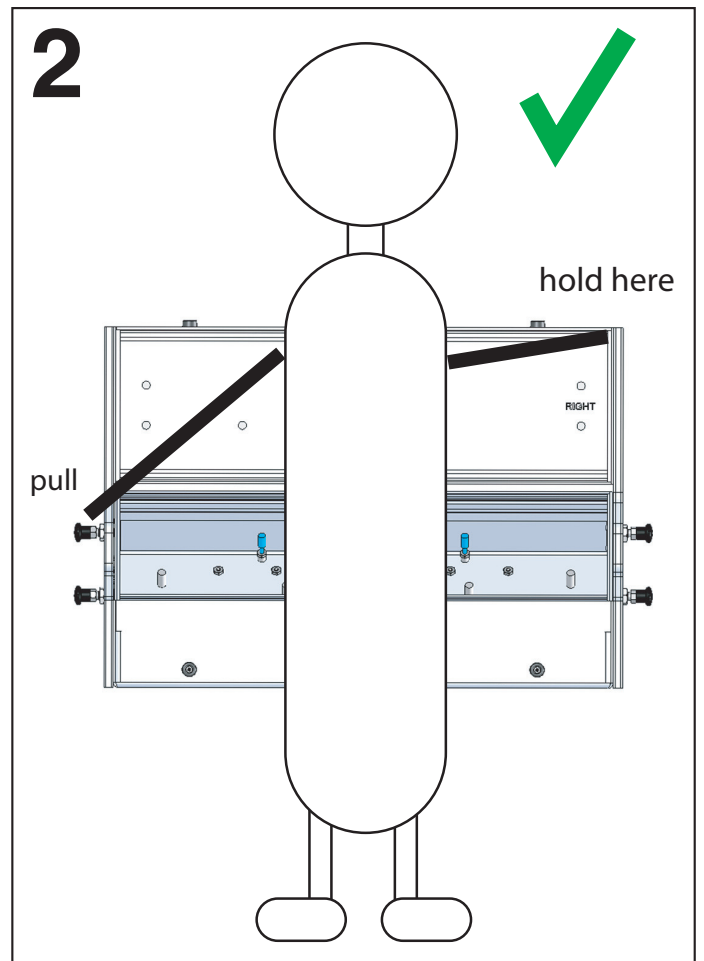
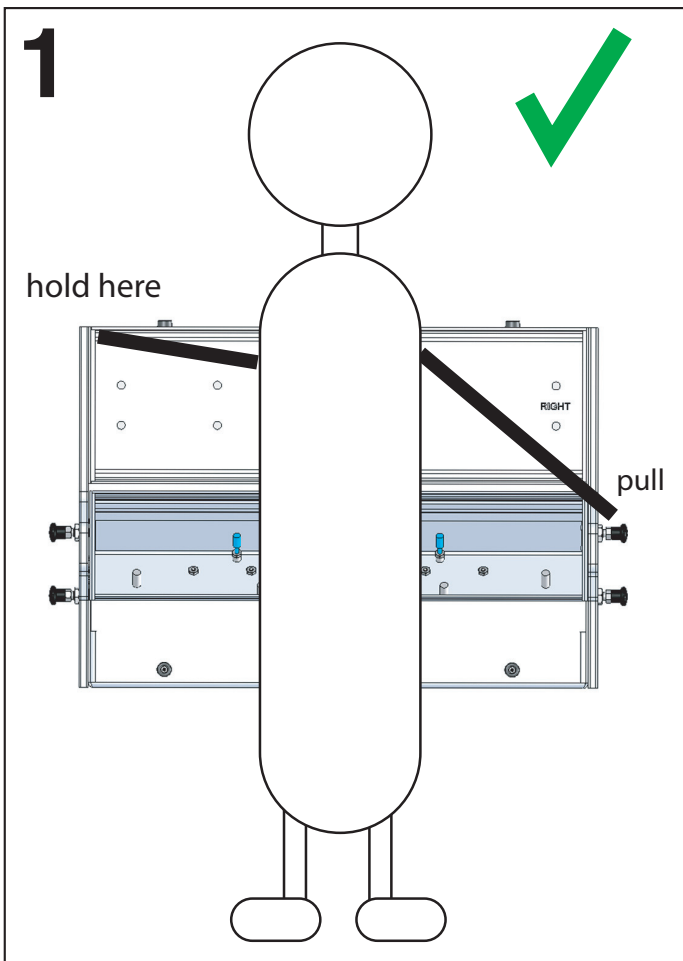

# **Station 252 USER Manual**

## **Introduction**

---

Welcome and thank you for choosing the **Tiptop Audio Station 252!**

This case is not a toy. Please exercise caution as there are moving metal parts that may cause harm if used without proper care. Supervision is advised around young children.

Your **Station 252** was hand assembled with the utmost care and assurance of mechanical precision. Each part was machined to its exact dimensions and size, so it is good to note that parts -- notably the holes for the locking-pins and the kickstand hinge -- may be a little stiff at first; however with regular use, over time your case will become smoother to operate.

The **Station 252** is compatible with all Cincon power supplies. These power supplies are universal and can be used in both 110VAC and 220VAC without the need of a transformer. For more information check out the Zeus Q-C Manual -> <http://www.tiptopaudio.com/manuals/zeusqc.pdf>

# STATION 252 USER MANUAL

## Play Mode

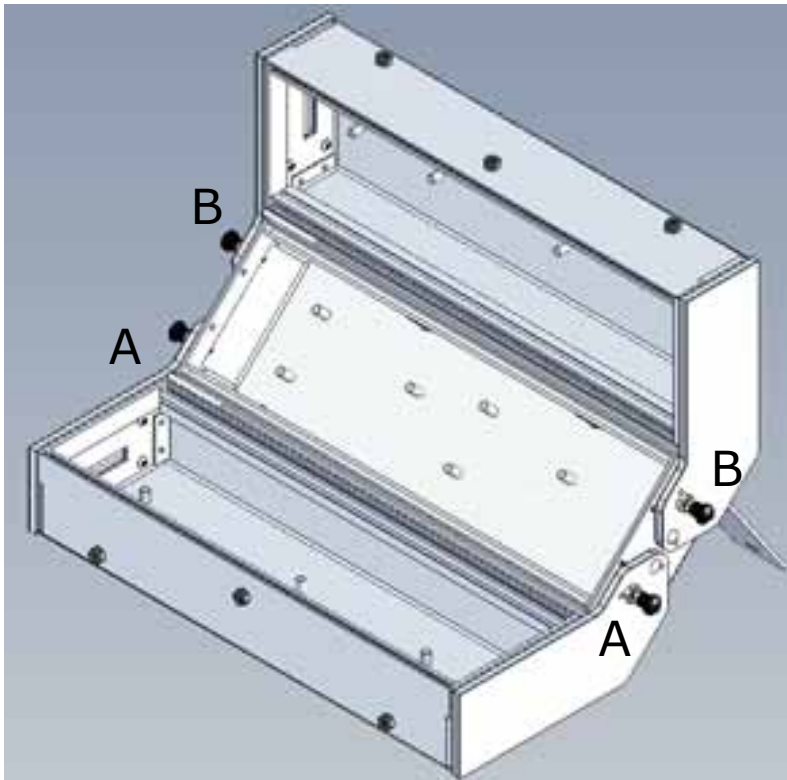

- A: Bottom Locking-pins
- B: Top Locking-pins
- 1: Magnetic Kickstand
- 2: 2.5mm Power Socket
- 3: Power Switch
- 4: Non-skid Strips
- 5: Handle

## Stationary Mode

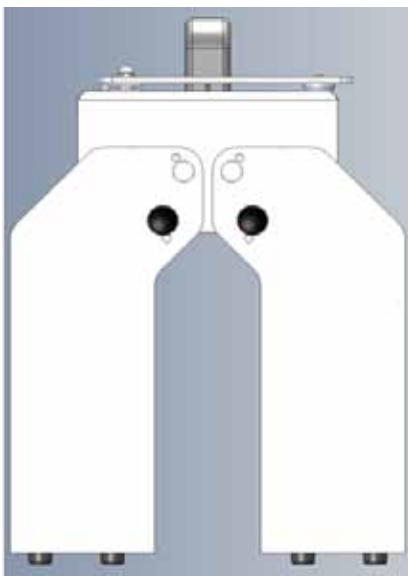

## Top View (Right-Side Up)



## Side View

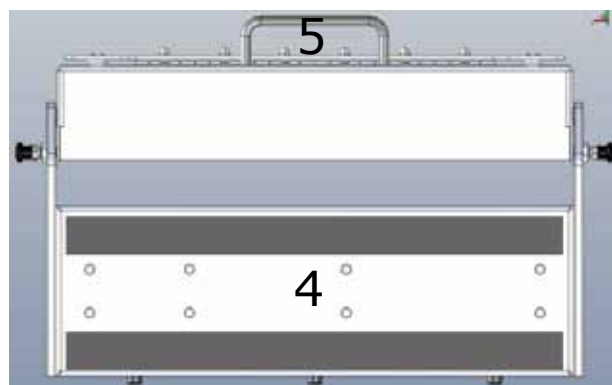

# Station 252 USER Manual

## Before you begin....

---

- ❖ Before pulling the locking-pins, make sure you always keep a hand on the top row of the case to prevent it from falling over.
- ❖ While operating the case, please exercise patience.
- ❖ When the case is closed, it is recommended that your case stay in its *Stationary Mode* with the handle perpendicular to the ground as shown in the previous page. This will minimize pressure caused by the case's weight on the locking-pin holes.

## Opening the Case

---

- ❖ When you're ready to use the case, place the side with non-skid strips on the surface.
- ❖ Pull out the metal kickstand.
- ❖ While holding the top row with one hand, use the other to open each bottom locking-pin (**A**) as shown in the picture, one at a time. Make sure you always keep a hand on the top row of the case to prevent it from falling over.

- ↳ **Tip:** To keep the locking-pins fastened in its open position, pull them out all the way then twist them one quarter of a turn. Twist them back to close.

Locking-Pin Positions

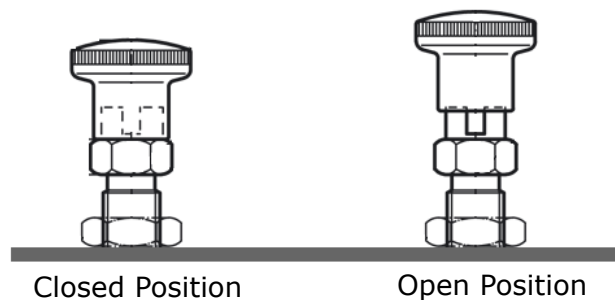

- ❖ Adjust the top row until the two bottom locking-pins (**A**) click into position. If they don't close automatically, gently push the locking-pins until it clicks into its fully closed position. Be sure locking-pins (**A**) are in their closed positions before moving on.
- ❖ Again, hold the top row with one hand and use the other to open each top locking-pin (**B**) one at a time until they click into place.
- ❖ Lastly plug in your power, turn on the switch, and make some music!

# **Station 252 User Manual**

## **Closing the Case**

---

- ❖ First, unplug your power.
- ❖ While holding the top row with one hand, use the other to pull out the top locking-pins (**A**) one at a time.
- ❖ Lock the top row into place before moving onto the bottom row. Again check the locking-pins and make sure they are in their closed position.
- ❖ Now while holding the top row still with one hand, pull out the bottom locking-pins (**B**) one at a time and lock it into its Stationary Mode.

# **Station 252**

